

GK8357

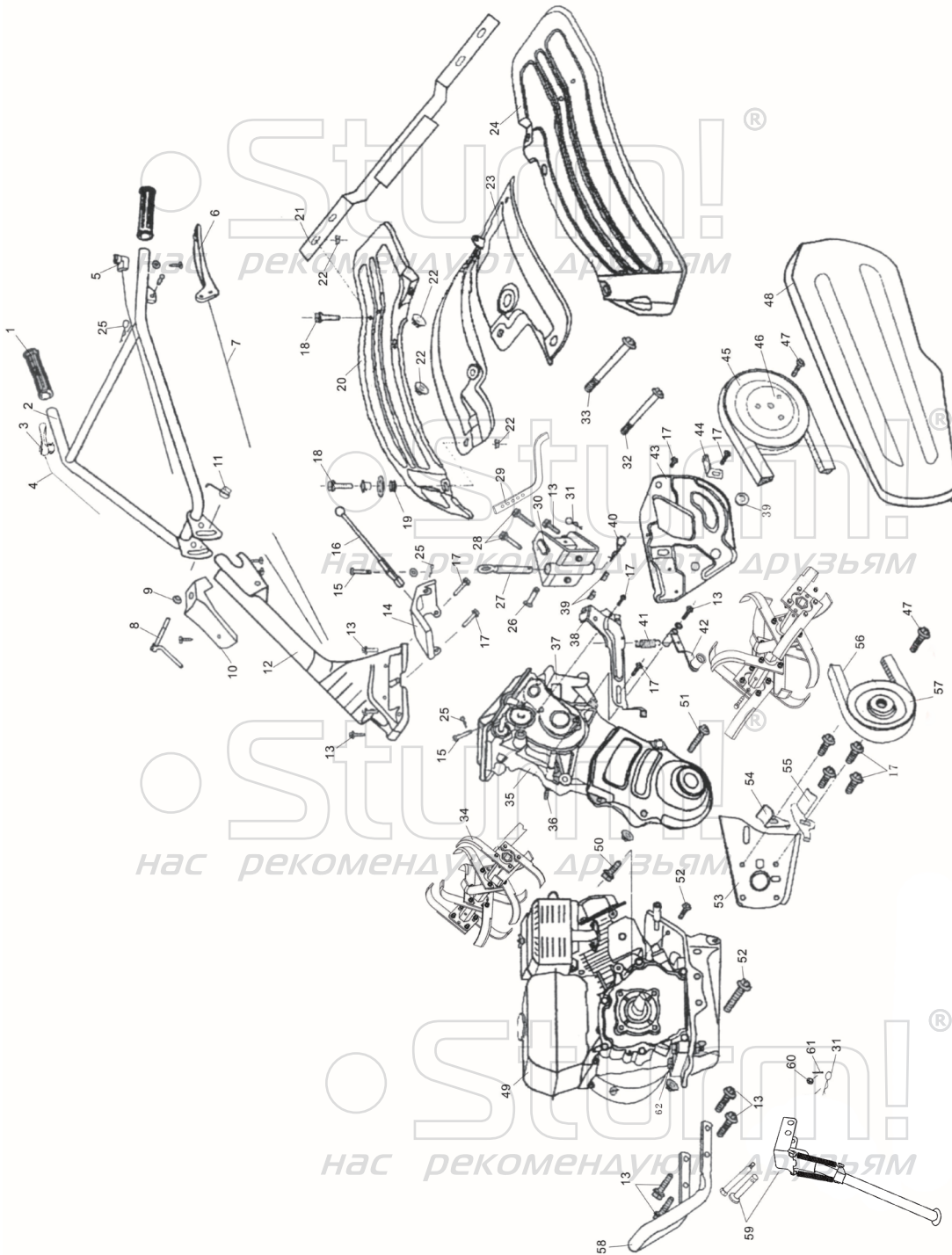

| NO. | DESCRIPTION | NO. | DESCRIPTION |
|-----|-----------------------------|-----|-------------------------------------|
| 1 | HANDLEBAR RUBBER | 32 | HEXAGULAR BOLT M8×65 |
| 2 | HANDLEBAR ASSY | 33 | HEXAGULAR BOLT M10×65 |
| 3 | THROTTLE SWITCH ASSY | 34 | BLADE ASSY. |
| 4 | THROTTLE SWITCH CABLE | 35 | TRANSMISSION ASSEMBLY |
| 5 | POWER SWITCH | 36 | TENSIONER SUPPORTING SHAFT |
| 6 | CLUTCH HANDLE | 37 | CONNECTING FRAME JOINTING ASSY |
| 7 | CLUTCH CABLE | 38 | TRANSMISSION COVER |
| 8 | ADJUSTABLE HANDLE LOCK ASSY | 39 | HEXAGONAL NUT M8 |
| 9 | BUSH | 40 | DISSIMILAR COTTER PINΦ3.0 |
| 10 | INTAKE COVER ASSY | 41 | TENSIONER SPRING |
| 11 | LOCK STOP BLOCK | 42 | TENSIONER ASSY |
| 12 | HANDLEBAR | 43 | TRANSMISSION COVER |
| 13 | HEXAGULAR BOLT M8×16 | 44 | PULLEY(BELT) COVER UPPER BRACKET |
| 14 | GEAR INDICATION | 45 | DRIVEN WHEEL |
| 15 | PIN SHAFT B5*28 | 46 | PULLEY COVER PLATE |
| 16 | SHIFT LEVER | 47 | HEXAGULAR BOLT M8×20 |
| 17 | HEXAGULAR BOLT M6×12 | 48 | BELT COVER |
| 18 | HEXAGULAR BOLT M6×20 | 49 | ENGINE ASSY. |
| 19 | WASHER | 50 | HEXAGULAR BOLT M8×60 |
| 20 | LEFT FENDER | 51 | HEXAGULAR BOLT M6×50 |
| 21 | FENDER REAR BRACKET ASSY | 52 | HEXAGULAR BOLT M8×70 |
| 22 | HEXAGONAL NUT M6 | 53 | TRANSMISSION CASE COVER |
| 23 | FENDER FRONT BRACKET ASSY | 54 | PULLEY(BELT) COVER UPPER BRACKET |
| 24 | RIGHT FENDER | 55 | PULLEY(BELT) COVER SUBFRAME BRACKET |
| 25 | DISSIMILAR COTTER PINΦ1.2 | 56 | BELT |
| 26 | PIN SHAFT B8*50 | 57 | DRIVING WHEEL |
| 27 | DRAGGING ITEM PIN | 58 | BUMPER |
| 28 | HEXAGULAR BOLT M8×40 | 59 | SUPPORTING FOOT ASSY |
| 29 | SPEED CONTROL ROD | 60 | 1-SHAPE SLOTTED AND CASTLE NUT |
| 30 | DRAGGING ITEM JOINTING ASSY | 61 | COTTER PIN 2.0×30 |
| 31 | DISSIMILAR COTTER PINΦ1.2 | 62 | HEXAGON HEADED BOLT |

RU-ST20161115

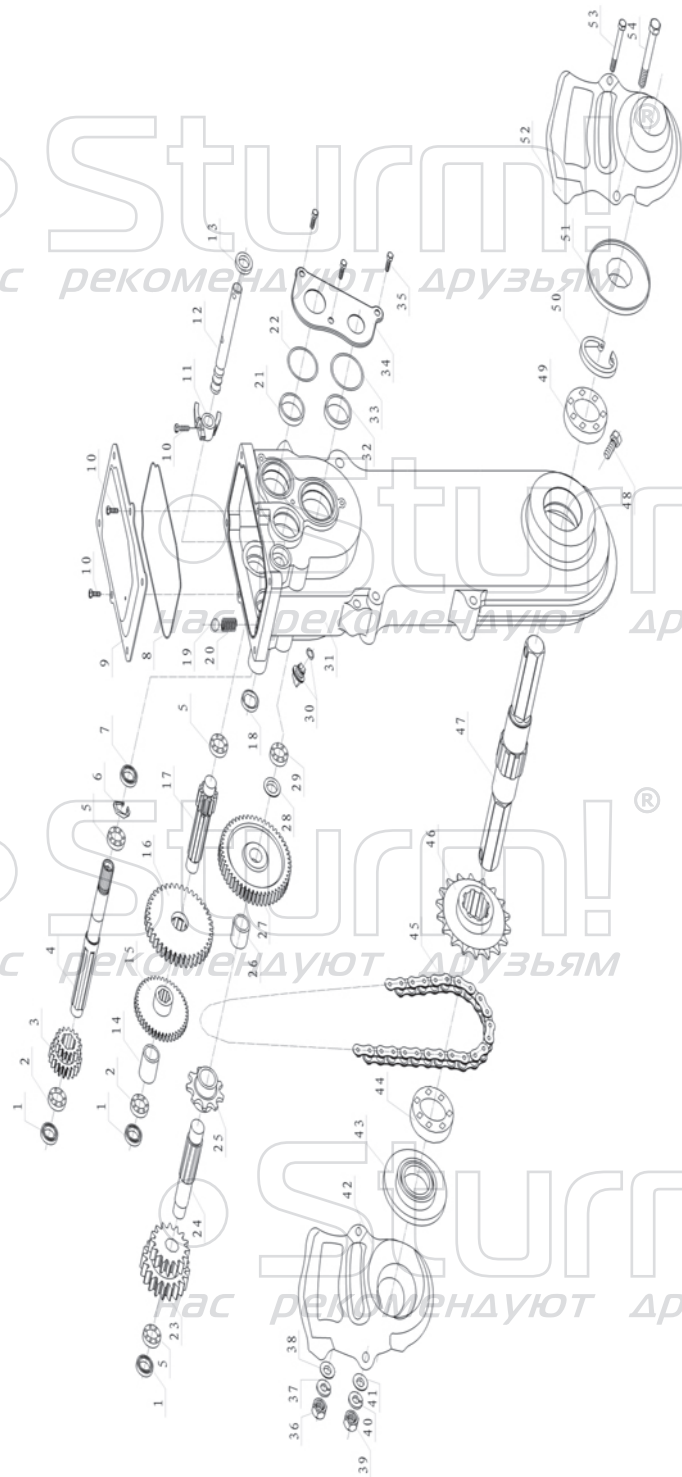

GK8357 GEAR BOX

| NO. | DESCRIPTION | NO. | DESCRIPTION |
|-----|---------------------------|-----|--------------------------|
| 1 | OIL PLUG | 28 | NONSTANDARD WASHER |
| 2 | BEARING 6002 | 29 | BEARING 6203 |
| 3 | SHIFT GEAR | 30 | OIL DIPSTICK |
| 4 | MAINSHAFT | 31 | TRANSMISSION CASE BODY |
| 5 | BEARING 6202 | 32 | BUSH |
| 6 | ELASTIC CIRCLIP FOR HOLE | 33 | SEALING O-RING |
| 7 | OIL SEAL | 34 | OIL SEALING PLATE |
| 8 | SEALING O-RING | 35 | HEXANGULAR BOLT |
| 9 | WHEEL BOX FENDER | 36 | HEXANGON NUT |
| 10 | HEXANGULAR BOLT | 37 | STANDARD SPRING WASHER |
| 11 | SHIFTING GEAR FORK SHAFT | 38 | WASHER |
| 12 | SHIFTING GEAR FORK | 39 | HEXANGON NUT |
| 13 | OIL SEAL | 40 | STANDARD SPRING WASHER |
| 14 | BUSH | 41 | WASHER |
| 15 | REVERSE GEAR | 42 | WHEEL BOX FENDER |
| 16 | TRANSITION SPUR GEAR | 43 | OIL SEAL |
| 17 | COUNTERSHAFT | 44 | BEARING 6005 |
| 18 | OIL PLUG | 45 | CHAIN |
| 19 | IRON SHOT | 46 | DRIVEN CHAIN WHEEL |
| 20 | POSITIONING SPRING | 47 | HEXAGONAL OUTPUT SHAFT |
| 21 | BUSH | 48 | OIL PURGE BOLT |
| 22 | SEALING O-RING | 49 | BEARING 6205 |
| 23 | DUPLEX SPUR GEAR | 50 | ELASTIC CIRCLIP FOR HOLE |
| 24 | DRIVING CHAIN WHEEL SHAFT | 51 | OIL SEAL |
| 25 | DRIVING CHAIN WHEEL | 52 | WHEEL BOX FENDER(RIGHT) |
| 26 | BUSH | 53 | HEXANGULAR BOLT |
| 27 | TRANSITION SPUR GEAR | 54 | HEXANGULAR BOLT |

RU-ST20161115

ENGINE FOR GK8357

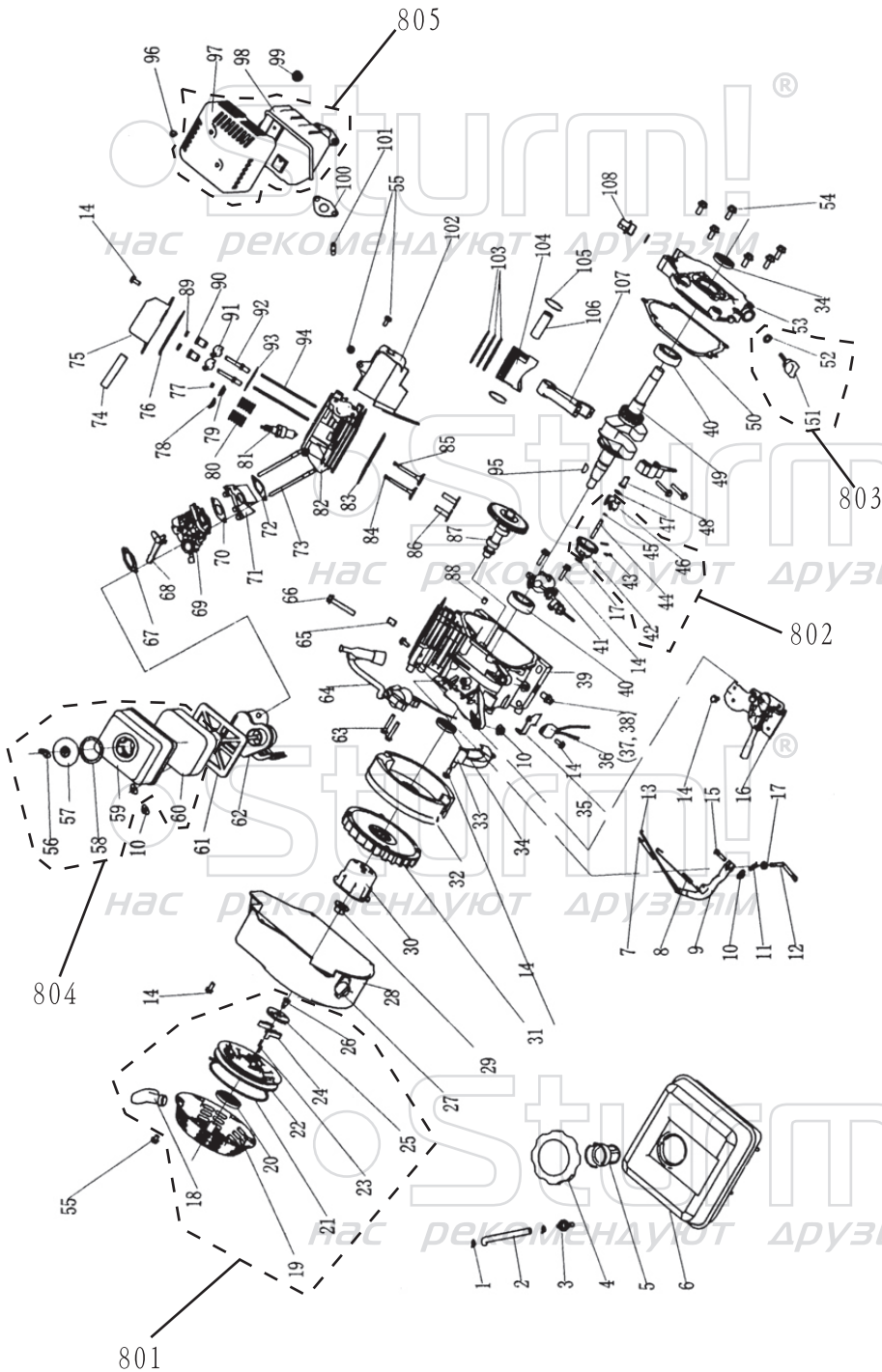

| NO. | DESCRIPTION | NO. | DESCRIPTION | NO. | DESCRIPTION |
|-----|------------------------------------|-----|-------------------------|-----|-------------------------|
| 1 | CLIP TUBE | 39 | CRANK CASE | 77 | RATATOR VALVE |
| 2 | TUBE FUEL | 40 | BEARING RADIAL BALL | 78 | SEAL GUIDE |
| 3 | JOINT ASSY FUEL TANK | 41 | OIL LEVEL SWITCH | 79 | RETAINER VALVE SPRING |
| 4 | CAP COMP FUEL FILLER | 42 | GEAR GOVERNOR | 80 | SPRING VALVE |
| 5 | FILTER FUEL | 43 | PIN GOVERNOR WEIGHT | 81 | PLUG SPARK |
| 6 | OIL TANK | 44 | SHAFT GOVERNOR | 82 | HEAD COMP CYLINDER |
| 7 | OIL LINE | 45 | CLIP GOVERNOR HOLDER | 83 | GASKET CYLINDER |
| 8 | SPRING THROTTLE RETURN | 46 | WEIGHT GOVERNOR | 84 | VALVE IN |
| 9 | ARM GOVERNOR | 47 | WASHER PAIN 6×15×0.5 | 85 | VALVE EX |
| 10 | NUT FLANGE | 48 | SLIDER GOVERNOR | 86 | LEFTER VALVE |
| 11 | PIN LOCK | 49 | CRANKSHAFT COMP | 87 | CAMSHAFT ASSY |
| 12 | SHAFT GOVERNOR ARM | 50 | PACKING CASE COVER | 88 | PIN FLYING BLOCK |
| 13 | ROD GOVERNOR | 51 | OIL FILLER CAP | 89 | NUT PIVOT ADJUSTING |
| 14 | BOLT FLANGE | 52 | PACKING OIL FILLER CAP | 90 | PIVOT ROCKER ARM |
| 15 | BOLT QUADRATE HEAD | 53 | COVER | 91 | ARM VALVE ROCKER |
| 16 | CONTROL ASSY | 54 | BOLT FLANGE | 92 | BOLT PIVOT ARM |
| 17 | WASHER PAIN | 55 | BOLT FLANGE | 93 | PLATE ASSY |
| 18 | KNOB RECOIL STARTER | 56 | NUT TOOL BOX SETTING | 94 | ROD PUSH |
| 19 | COVER COMP FAN | 57 | COVER AIR CLEANER | 95 | KEY SPECIAL WOODRUFF |
| 20 | SPRING RECOIL SATRTER | 58 | SEAL AIR CLEANER | 96 | SCREW TAPPINIG 5*8 |
| 21 | REEL RECOIL STARTER | 59 | COVER AIR CLEANER | 97 | PROTECTOR MUFFLER |
| 22 | ROPE | 60 | FILTER OUTER | 98 | MUFFLER ASSY |
| 23 | SPRING RETURN | 61 | AIR CLEANER PLATE | 99 | NUT HEX 8MM |
| 24 | RATCHET STARTER | 62 | ELBOW COMP AIR CLEANER | 100 | GASKET MUFFLER |
| 25 | GUIDE RATCHET | 63 | BOLT FLANGE 6*25 | 101 | BOLT STUD EXHAUST |
| 26 | SCREW SETTING | 64 | COIL ASSY IGNITION | 102 | SHROUD |
| 27 | SWITCH ASSY ENGINE STOP(OIL ALERT) | 65 | PIN DOWER | 103 | RING SET |
| 28 | COVER COMP FAN | 66 | BOLT FLANGE 8*55 | 104 | PISTON |
| 29 | NUT SPECIAL | 67 | SPACER COMP AIR CLEANER | 105 | CLIP PISTON PIN |
| 30 | PULLEY STARTER | 68 | LEVER COMP CHOKE | 106 | PIN PISTON |
| 31 | FAN COOLING | 69 | CARBURETOR | 107 | CONNECTING ROD |
| 32 | FLYWHEEL COMP | 70 | PACKING CABURETOR | 108 | OIL STICK |
| 33 | DIVERSION ASSY | 71 | INSULATOR CARBURETOR | 801 | RECOIL STARTER |
| 34 | OIL SEAL 25*41.25*6 | 72 | PACKING INSUL ATOR | 802 | GEAR GOVERNOR ASSEMBLY |
| 35 | PLATE SIDE SUPPORT | 73 | BOLT STUD IN | 803 | OIL FILLER CAP ASSEMBLY |
| 36 | ALART UNIT OIL | 74 | TUBE BREATHER | 804 | ARI FILTER |
| 37 | BOLT DRAIN PLUG | 75 | COVER COMP HEAD | 805 | MUFFLER |
| 38 | WASHER DRAIN PLUG 10×15×1.2 | 76 | PACKING HEAD COVER | | |

RU-ST20161115